

United Roofing Products

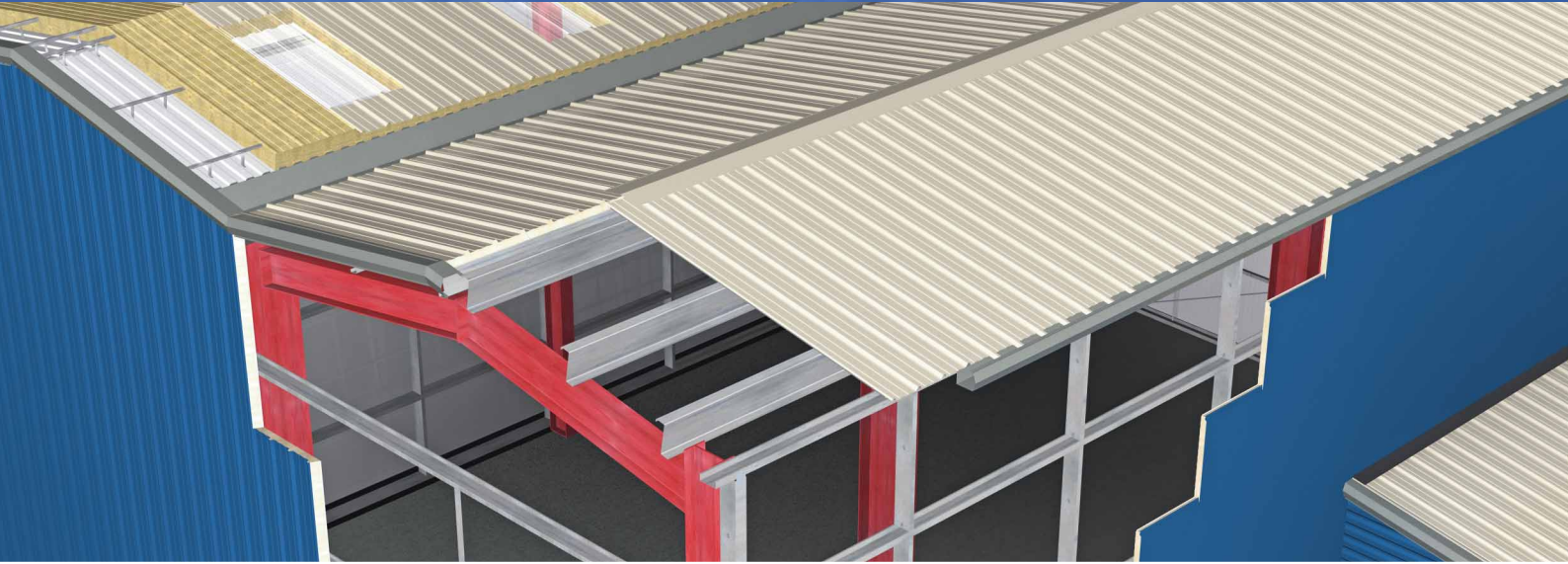

PRODUCT RANGE



The South West's leading manufacturer and supplier of metal sheeting, cladding and all products incorporated in the agricultural and industrial building envelope.

We manufacture, stock or source all the requirements for the agricultural market, specialist contractors, frame builders and end users alike. From the steel frame out we have it all under one roof.

We offer rapid, cost effective, made to measure systems and products to minimise waste and site work to suit any project in the sector.

We have a skilled team with technical support who are happy to discuss and advise you on the requirements for your project of any size.

We are a founding member of the RIDBA organisation and are a very active participant within the association.

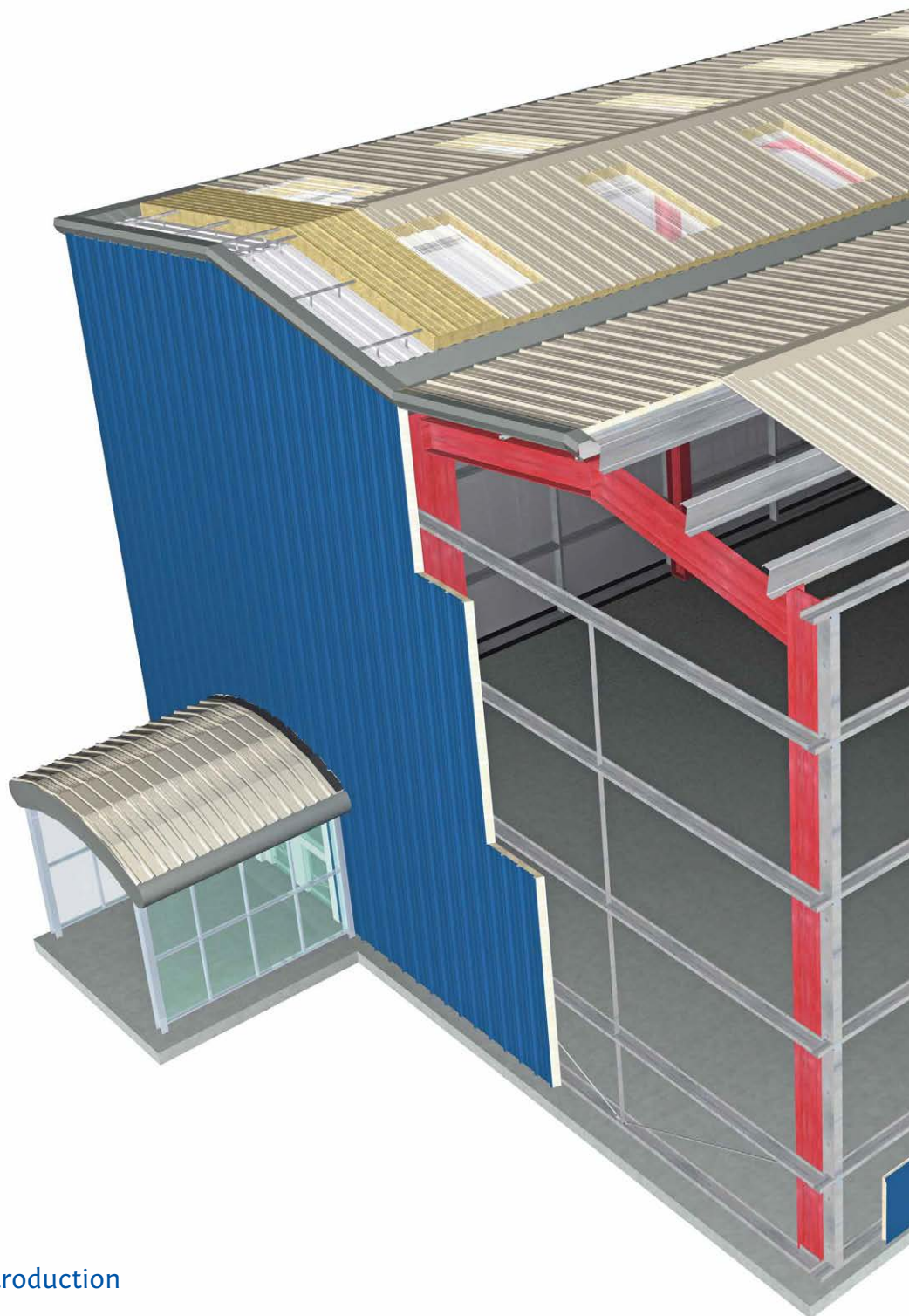

Introduction

In this brochure you will find information and images of our systems and solutions for a range of construction applications for the agricultural and industrial building sector.

The applications cover composite and twin skin insulated solutions, unique ventilation systems, condensation control, secondary structural steelwork, rainwater management, flashings, fabrications, right down to the last fixing.

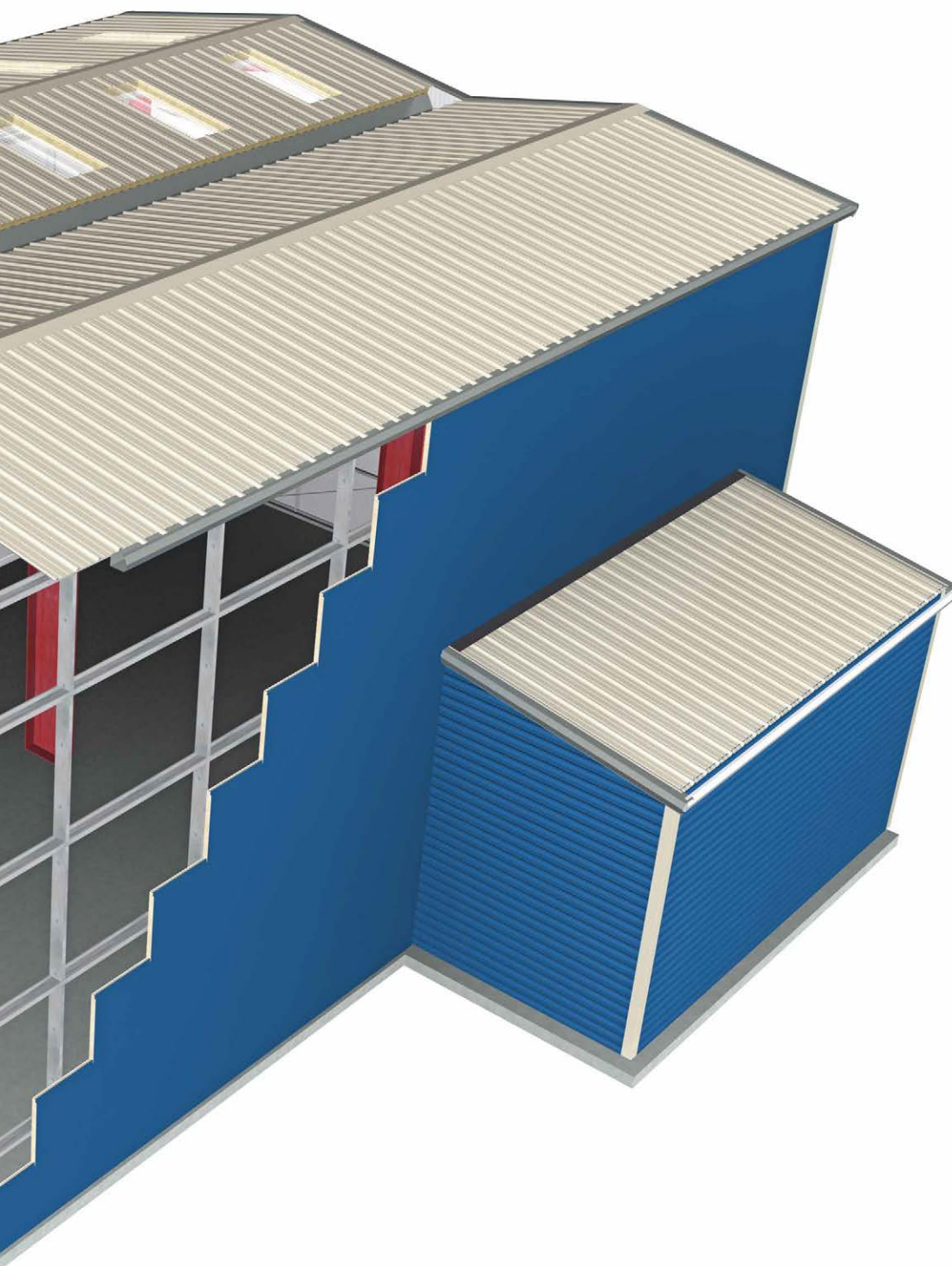

Contents

Introduction	02
Single skin roofing and cladding systems	04
Condensation control - AntiCon	05
Insulated twin skin and over roofing systems	06
Insulated composite roof and wall systems	07
Secondary structural steelwork	08 - 09
Light and ventilation in farm buildings	10 - 11
Technical support	12
Environmental credentials	12

Whatever the nature of your project, United Roofing Products (URP) offer the product solutions, certification, warranties and the experience and expertise essential to its success.

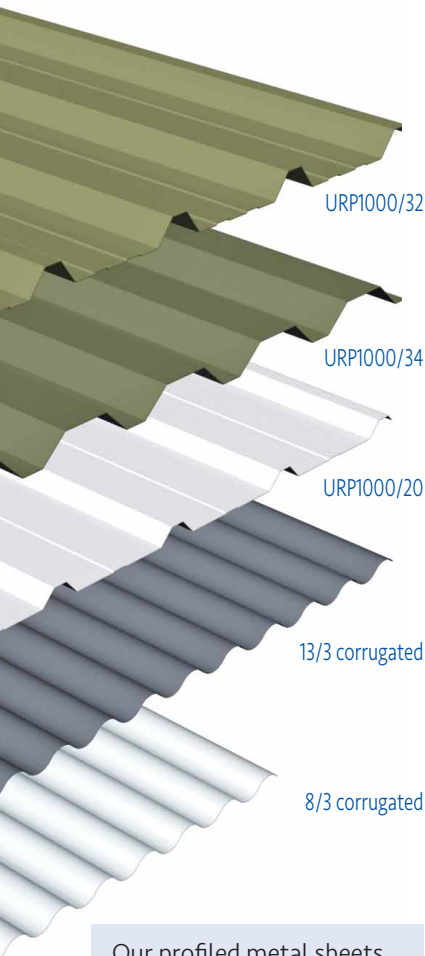

Our profiled metal sheets are designed for roofing and cladding on industrial, commercial and agricultural buildings.

Profiled sheets are available in 0.4mm, 0.5mm and 0.7mm thick steel in Plastisol and Polyester finishes.

There are 2 deep profiles and a 3 inch corrugated profile for roofing and cladding, along with a shallow liner profile.

We offer a profile identification service for repairs and refurbishment. We can source or manufacture current, obsolete or bespoke profiles to any requirement.

Profiles

URP1000/32 Roof and Wall sheet:

a 1m cover, 32mm deep profile for roofing and wall cladding. Available in Plastisol and Polyester finishes.

URP1000/34 Roof and Wall sheet:

a 1m cover, 34mm deep profile for roofing and wall cladding. Available in Plastisol and Polyester finishes.

URP1000/20 Liner sheet:

a 1m cover, 20mm deep liner profile coloured white on one face, for internal lining of walls and roofs, which can be installed above or below the purlins.

URP1000/32 0.7mm Liner sheet:

a 1m cover, 0.7mm thick, 32mm deep liner profile coloured white on one face, for internal lining of walls and roofs, which can be installed above or below the purlins.

13/3 corrugated sheet:

a 990mm cover, shallow profile corrugated sheet. Available in Plastisol, Polyester and plain galv. Also available in 8/3 (608mm cover) in plain galv.

Steel Specification

The steel is either hot-dip galvanised to BS EN 10346:2009 or Aluzinc coated, then finished in one of our colour coatings. We offer a full range of different finish options (see right) in a variety of colours.

Please see our Single Skin Roofing and Cladding brochure or website for more details.

Requirements

URP's profiled metal sheets are CE marked to BS EN 14782:2006.

A copy of the Declaration of Performance is available on our web site.



Daylight Systems

We offer a full range of GRP Rooflights either from standard stock lengths or cut to order. Other custom solutions are available including Polycarbonate, Barrel Vault and Sun Tubes.

Finishes

Plastisol Leathergrain: an embossed PVC 200µm thick, factory-applied colour coating, which is tough and scratch resistant with a long lifespan.

Polyester: a factory applied, lower cost coating which is suitable for use on agricultural buildings.

A range of alternative coatings available including Polyurethane, PVDF and metallic finishes.

Curving

Box profiles are available crimp curved for curved eaves and crank ridge applications. The 13/3 corrugated profile is available smooth curved for Dutch barns, pig arcs and Shepherd huts.

Accessories

We offer a comprehensive range of fixings, sealants, flashings, in-plane roof lights, gutters, downpipes - all designed to co-ordinate and match each roof profile.



Condensation

When warm, moist air within a building comes into contact with cold surfaces there is a risk of condensation as the air cools and is unable to support the same amount of moisture. This commonly occurs on the underside of roofs in un-insulated single-skin metal buildings during the winter, and also on clear nights when night sky radiation substantially lowers the temperature of the roof surface.

Condensation can run down the roof and collect on or within the building fabric where it will cause rust, rot or damage to fittings, or may drip from the roof.

AntiCon condensation control

AntiCon is a fleece designed to reduce the risk of damage from dripping or running condensate on un-insulated single skin metal roofs in buildings with moderate to high humidity levels and low ventilation.

Condensation is controlled by AntiCon in an environment where condensation occurs cyclically. It does not prevent condensation and is damp to the touch when functioning. For the fleece to work properly the building has to be adequately ventilated to allow the material to dry out between the cycles.

AntiCon is suitable for use on roofs at all pitches of 5° and above; more moisture is retained at lower pitches and therefore endlap treatment is required for roofs between a 5 - 10° pitch.

The AntiCon fleece absorbs and holds condensate until it can evaporate, whilst slowing its formation by insulating the sheeting and preventing dripping from the underside of the roof.

Benefits of AntiCon

- Holds condensate safely until it evaporates.
- Prevents condensate dripping from the underside of the roof.
- Slows the formation of condensate by insulating the sheeting.
- Fire Classification A2-s1,d0.
- AntiCon has good resistance to most acids, hydroxides and sulphides and does not support the growth of bacteria or mould.
- If necessary, AntiCon can be cleaned by pressure washing with water.

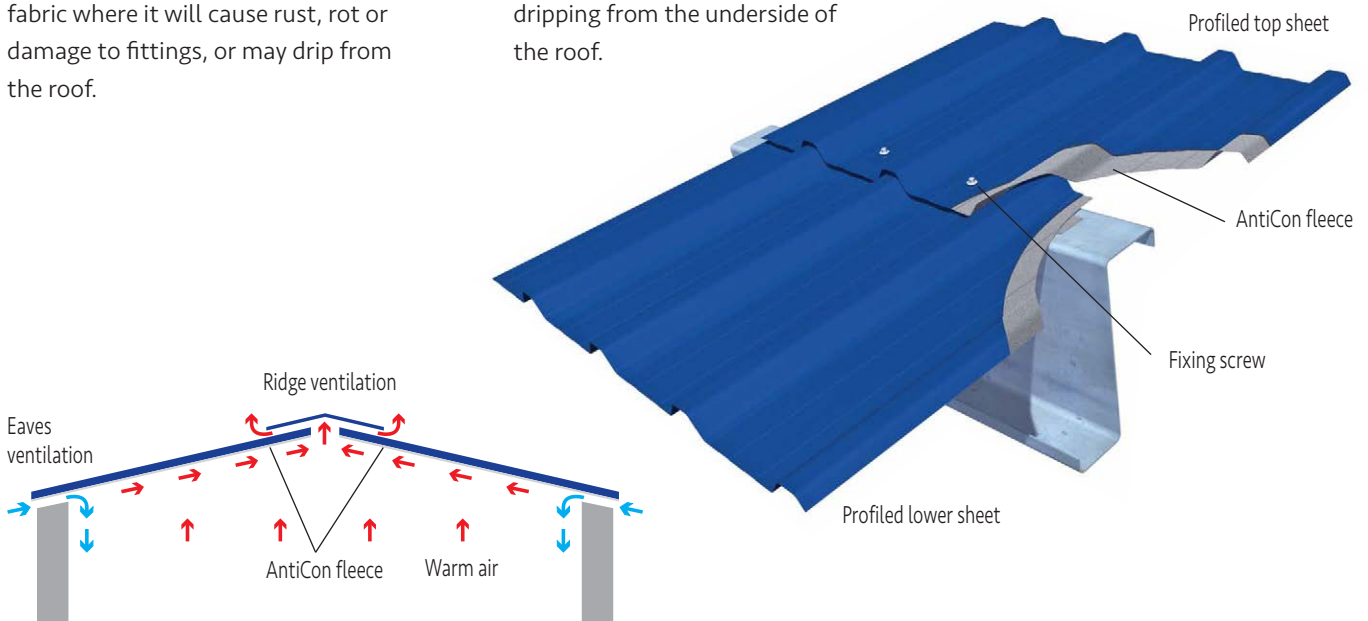

Insulated twin skin and over roofing systems



URP offer twin skin and over roofing systems utilising steel profiled sheets and steel bar and bracket spacing system to create a roof void of various depths, which can be filled with insulation to create an insulated roof. There by eliminating any condensation and creating a thermally and acoustically efficient roof or wall covering.

Spacing system

The spacing system comprises of a roll formed steel bar and interlocking brackets, which assemble without the requirement for fasteners to form a grid. This method results in a light weight yet very strong, rapidly installed and cost-effective sheeting rail that is elevated to the required height by the bracket.

The brackets range in height to create varying depth voids and create solutions for a huge range of various thermal, acoustic and fire resistance criteria. The bracket's narrow base allows the system to be fixed into the valley of the liner or existing roof profile, even those that are sinusoidal and fibre cement. This transfers the weight of the new roof cladding system directly onto the existing substructure of the roof.

Twin skin

URP manufactures a range of box profile sheets that can be incorporated into roof and wall twin skin systems. These systems generally comprise of an internal lining sheet, spacing system, insulation and a box profile top sheet (see page 4). Various depths, insulation types and configurations can be used to achieve the required specification for nearly all applications.

URP's unique position as a manufacturer but also major distributor of all metal sheeting and cladding products gives us access to all the technical knowhow and the full range of materials to offer solutions to all building envelope scenarios. Including rooflighting, high performing fire wall systems, structural roof decks, acoustic system, aluminium standing seam and secret-fix systems as well as the diversely flexible and cost effective box profile twin skin system.

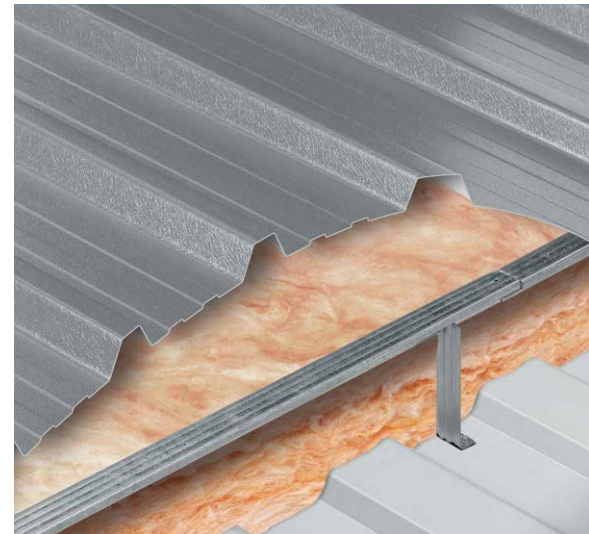

Over roof

The spacing system comes into its own in the refurbishment market. Whether you have a leaking roof, wish to increase the thermal & acoustic performance of your roof or wall, or simply improve the aesthetics of your property the spacing system offers quick cost effective solutions. Simply assemble the bar and bracket to replicate the substructure beneath the existing weather sheet, fix the bar and bracket system using the appropriate fasteners leaving the existing covering in place, insulate if desired and fix the new weather sheet. This solution quickly and cost effectively transforms the appearance and performance of existing buildings.

URP can produce thermal and acoustic calculations, offer a range of fire wall systems and provide solutions for aggressive environments.

A full set of fitting instructions and construction details available on request.

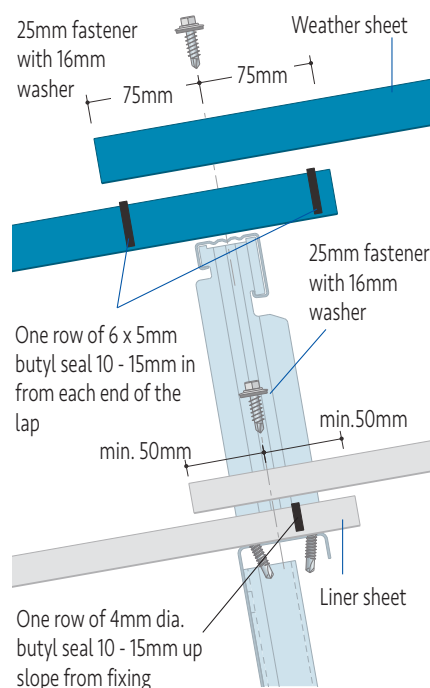

End lap fixing details - roof profiles

(Note: insulation omitted for clarity)

Insulated composite roof and wall systems



URP offer a wide range of LPCB insurance certificate approved Polyisocyanurate core (PIR) and mineral wool panels designed to suit all roof and wall applications.

Composite panels consist of a core of high density PIR or mineral wool insulation sandwiched between an external weather sheet and an internal liner sheet.

The composite panel offers an extremely quick and thermally efficient solution for the building envelope. There are significant benefits to using composite panels in regards to making cost and time savings during the schedule of the build. The products go through rigorous testing to ensure their thermal, structural and air leakage performance over the course of their lifetime.

You can have peace of mind if you choose composite panel as the systems come with a 25 year warranty and coating warranties of up to 40 years. You must register the building with the manufacturer on completion of the build.

In regards to fire performance, there are panels available to meet most stipulations that building control specify for either boundary wall or internal partition application.

As standard the roof panels come with a 0.5mm Plastisol coated trapezoidal box profile weather sheet and a very shallow ribbed 0.4mm Polyester white liner. There are insulations available in a range of depths from 40mm up to 150mm, with a cover width of 1m, cut to your specified lengths of up to 12m on standard transport (29.3m max length). Short sheets may be subject to a surcharge. There are a wide range of alternative coatings, liner and profiles available on request.

The standard roof panels provide the most cost effective option for vertical cladding. Alternatively there is a perpetually expanding range of architectural wall panel systems, available to suit the growing demand for modern design solutions that won't break your budget

We can provide any technical support and advice on request, including construction details.

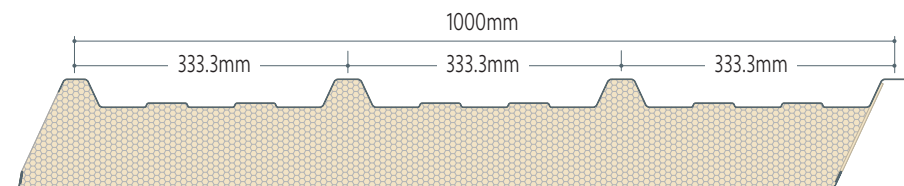

Trapezoidal roof & wall panel dimensions

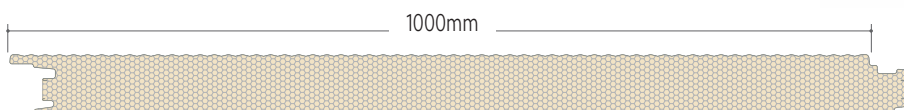

Micro-rib wall panel dimensions

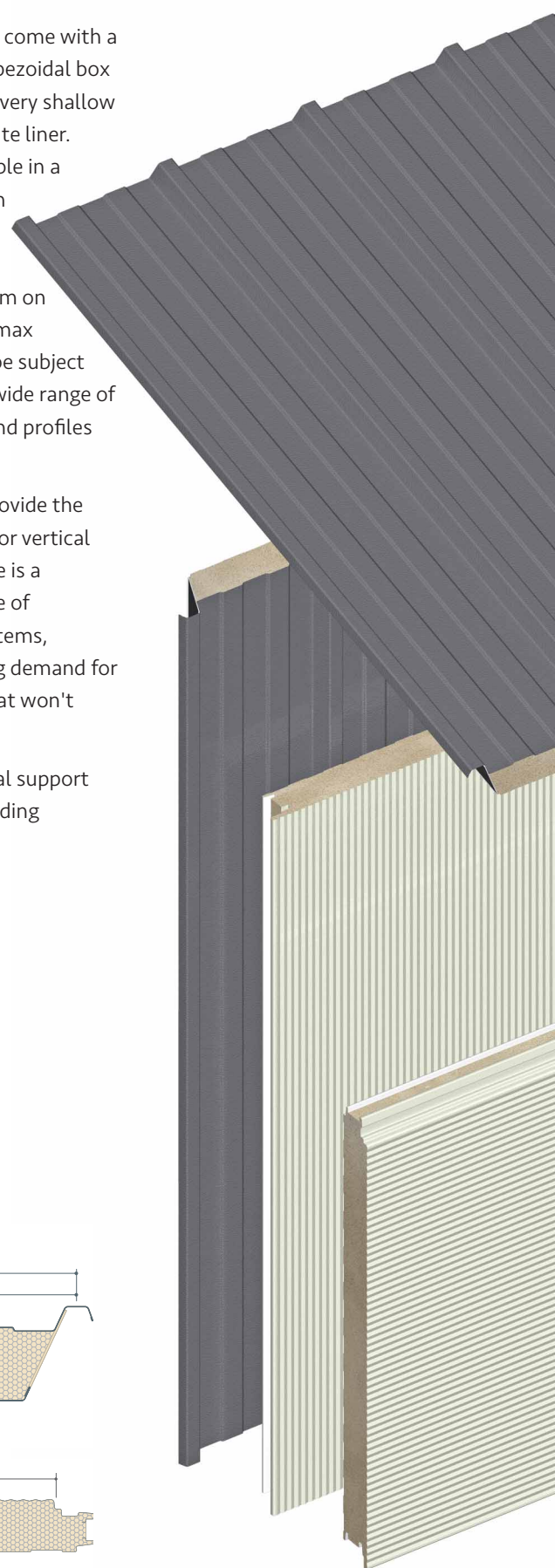

Secondary structural steelwork



URP supply a range of purlin and side-rail systems in a variety of Zed, Cee and Eaves Beam sections. They are available in depths from 140mm to 300mm and steel gauges from 1.4mm to 3.0mm as standard. To complete the system, a full range of integral accessories are also manufactured to measure.

Our cold rolled building products are manufactured from high tensile S450GD steel with Z275 galvanised finish.

To complement our building envelope solution we offer design assistance for all types of portal frame or roof construction projects.

Purlins are manufactured to suit multiple span conditions.

Double span, sleeved or non-continuous sections are

utilised to create clear spans of up to 12 metres and achieve optimum construction efficiency.

Consideration of the cladding system to be utilised is always accounted for at design stage and will be denoted on the project overview.

Eaves Beams are available in an optimised section range of 200, 240 and 300mm deep with multiple gauge choices to suit span conditions. All eaves beams can be supplied with a positive or negative angle to the top flange. Negative angles are used in mono-pitch roof construction to offer building stability at the eaves.

Channel sections also range from 140-300mm deep and are used in portal frames as side cladding rails, panel joint rail configurations, door trimmers

and mezzanine floor systems. Load tables are available on request.

Our key services:

- Assisted design and preliminary take-off service.
- Design software used is to the latest EC3 building codes.
- Fully CE marked on standard and non-standard Purchaser Provided CE (PPCE) sections.
- Notching and non-standard hole configurations available on all sections.
- Technical expertise and site visits.
- Our standard cold rolled sections are available in Tekla, Advanced Steel and Strucad for ease of detailing.
- Alternative coatings available for agricultural and corrosive environments.

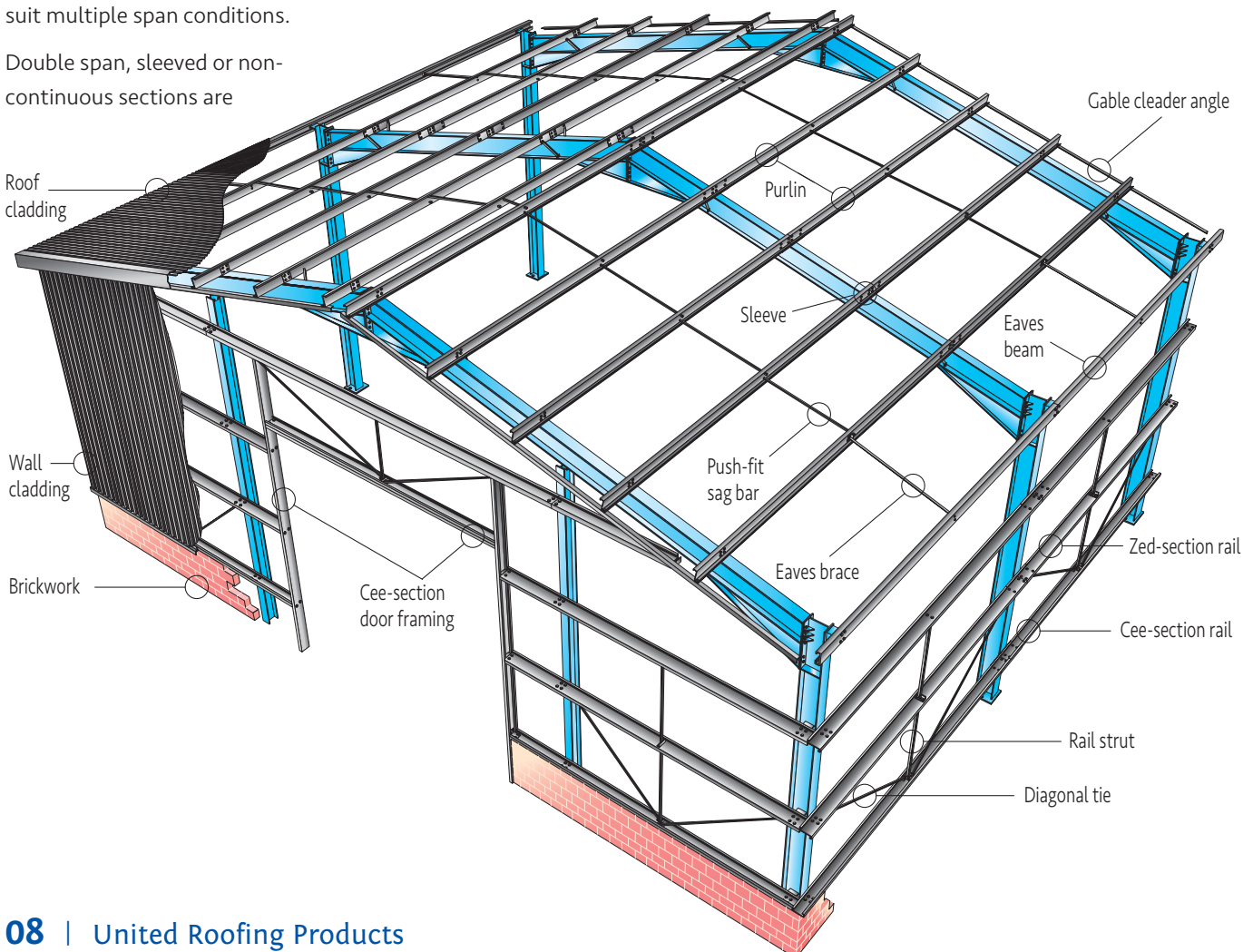

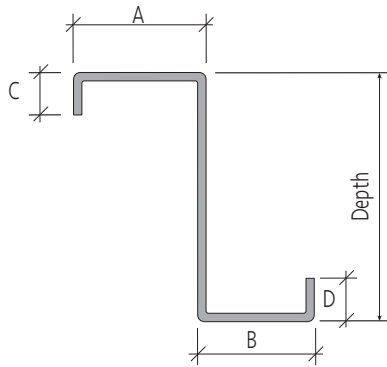

Zed & Cee profile dimensions

Section Depth	Zeds				Cees	
	A	B	C	D	E	F
140,170	60	54	16	20	62	13
200	70	64	16	20	70	15
240	75	67	18	22	74	17
300	95	87	21	25	95	19

Dimensions in mm

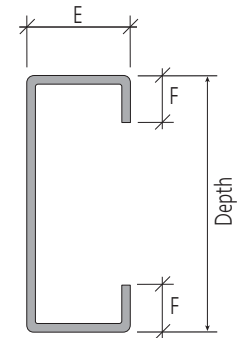

200 EAVES BEAM series

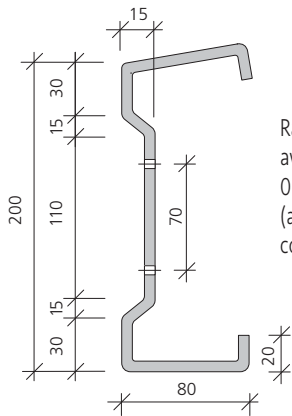

Rake to flanges available from 0° to 35° (above 35° contact URP)

240 EAVES BEAM series

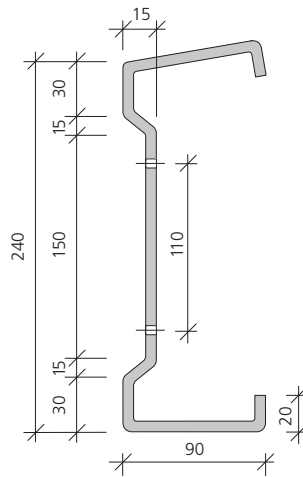

300 EAVES BEAM series

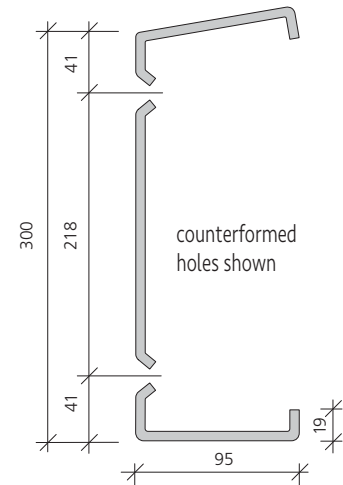

Cleat section depth

Section depth	A
140	58
170	88
200	118
240	158
300	218

Dimensions in mm

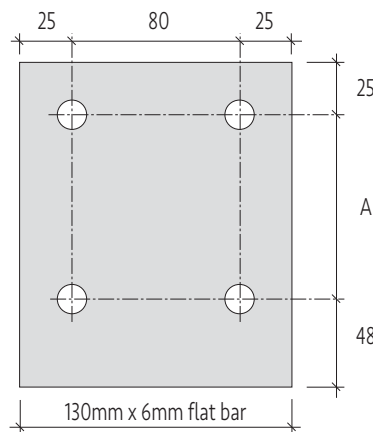

Welded Cleats

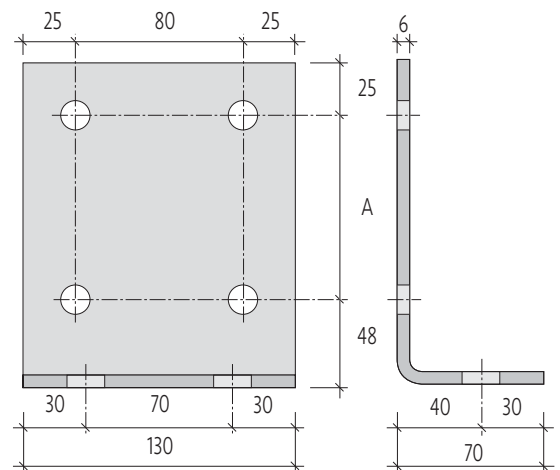

Bolt-on Cleats

Standard formed cleats - finish: black mild steel

Note for formed cleats:

- Holes in cleat upstand are 14mm dia for M12 grade 8.8 bolts.
- Holes in base plate for bolt-on cleats = 18mm dia.
- On request heavy duty cleats can be supplied.

Light and Ventilation in farm buildings



With the ever increasing focus on animal welfare in agriculture and the benefits that good natural light and ventilation brings to livestock, URP are focused on developing systems that improve the performance of agricultural buildings in these respects. This improved performance particularly in the case of ventilation has been shown to reduce vets bills and increase productivity of the livestock.



Ventridge - Open Protected Ridge System

The Ventridge ventilating metal ridge system is designed to improve the ventilation of livestock buildings whilst inhibiting weather ingress. Often used in conjunction with ventilated cladding, the system provides an excellent environment for all livestock, improving animal well-being and productivity.

The Ventridge system can be incorporated into the design of new buildings; it can be easily and economically retro-fitted to existing roofs. The minimum recommended pitch is 8°.

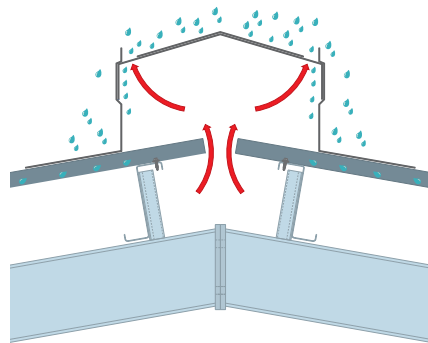

Perforated Upright Ridge

This simple solution consists of a perforated “mini-zed” upstand fixed to the crown of your profiled sheets, to which a ridge capping is then installed. This system provides more protection from the elements where lower levels of airflow are required at the ridgeline.

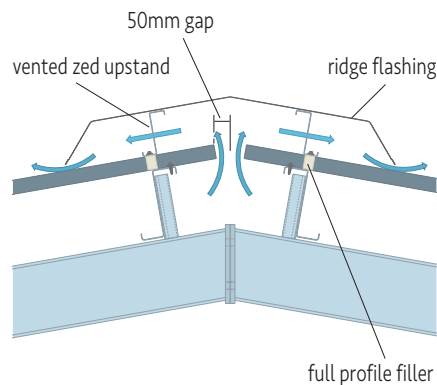

Ventair

Ventair is a box profile wall cladding sheet with louvred slots punched in the wide pan of the profile. This solution provides good protection from the elements whilst allowing airflow in through the walls lending itself for use in exposed elevations.

It is available in a range of colours and finishes cut to length to your specification.

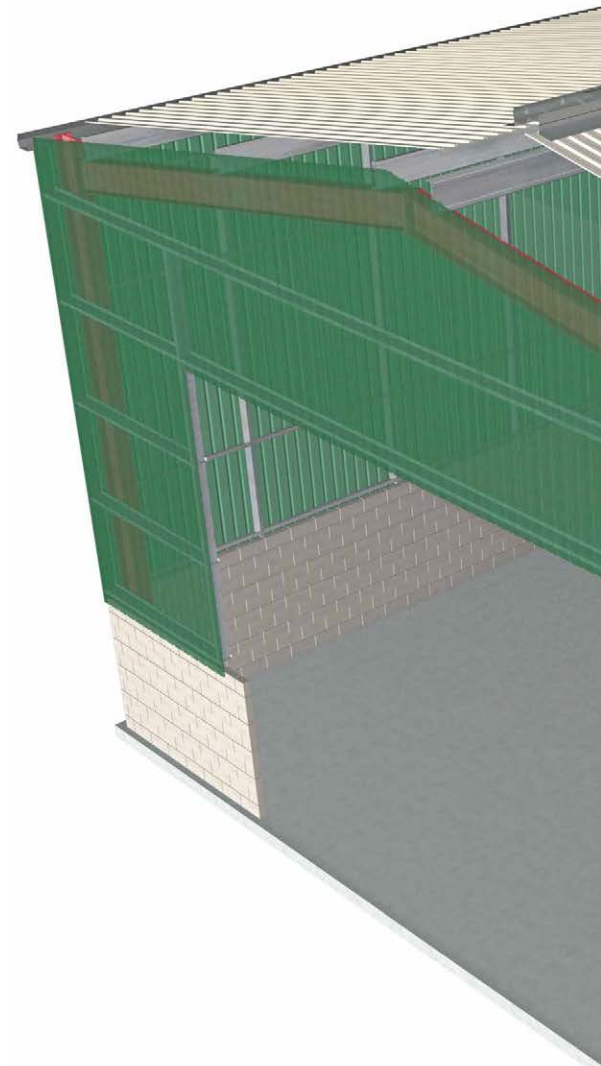

Light and Ventilation in farm buildings

Spaced Roofing

Spaced Roofing is run in a strong 1000/34 profile with an upturn at both sides of the sheet, with the intention for the sheets to be laid with a small gap running ridge to eaves. This design inhibits most of the weather entering the building whilst allowing the roof to breathe. Cut to length to your specification in a range of colours and finishes.

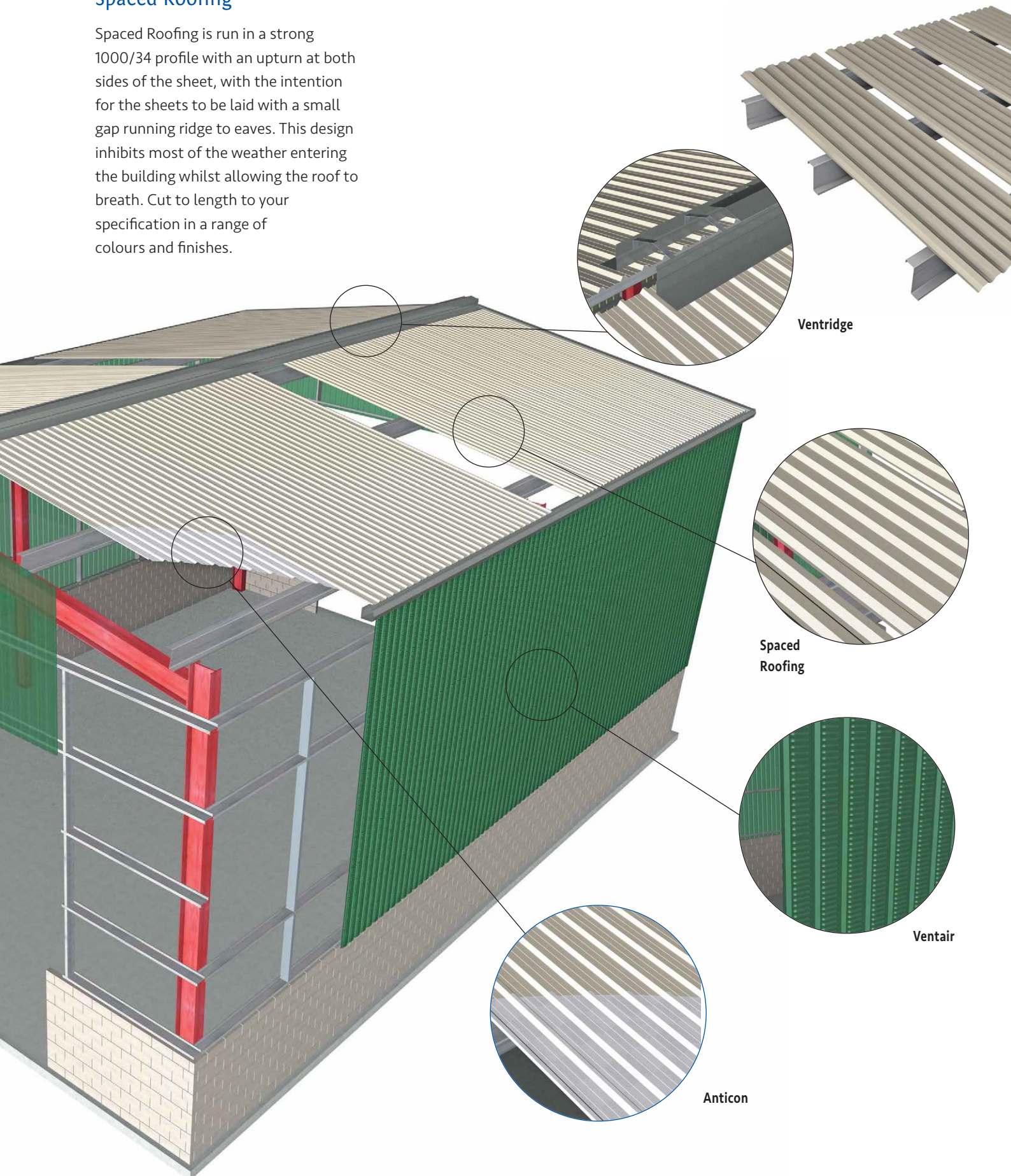



Longbridge Meadow Ind Estate • Cullompton • Devon • EX15 1BT • UK

Tel: 01884 839 302 • Fax: 01884 839 029 • Email: sales@unitedroofingproducts.com • www.unitedroofingproducts.com

Technical Support

We offer free technical support for all our products, including:

- technical data sheets;
- copies of test certificates;
- loading calculation;
- design and installation guidance.

Call us on 01884 839302 or email queries to sales@unitedroofingproducts.com.

Copies of all our product information are available on our web site: www.unitedroofingproducts.com

Environmental Credentials

We are keen to reduce the impact our business and processes have on the environment and the communities we live in.

While the introduction of sustainable construction methods is a challenge to the whole construction industry, our main raw material – steel – is widely recycled: 85 - 90% of steel from demolition goes for re-use and 40% of steel used in new construction has been recycled.

By using modern machinery and upgrading our facilities we are continually reducing the impact of our products on the environment, and improving their contribution to the long-term performance of buildings.

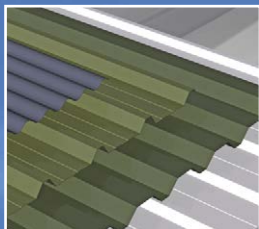

Single skin profiles



Composite panels



Purlins & Rails

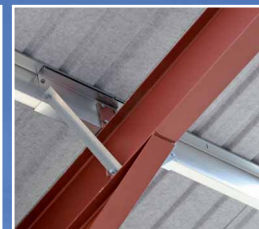

Condensation fleece

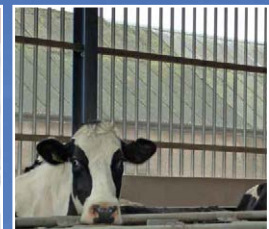

Ventilated cladding



Gutters



Flashings



Ventilated ridge



Fixings & sealants



Aluminium products

© Building Solutions (National) Ltd: The information contained within this document is correct at the time of publication but Building Solutions (National) Ltd (The Company) does not accept liability for errors or information found to be misleading. The Company reserves the right to change product details and specifications without prior notice.

A customer must satisfy itself that the Company's products are suitable for the customer's needs.

The Company undertakes business solely on its terms and conditions. Registered in England and Wales No. 11912299.



Assessed to ISO 14001
Cert/LPCB ref 42234



Assessed to ISO 18001
Cert/LPCB ref 42234